



YLI ELECTRONIC



# Magnetic Lock(280kg)

## Specification

Model	Size(unit:mm)	Voltage	Current	Holding Force	Lock Signal	Door Signal	Door
YM-280N(LED)-DS	250Lx48.5Wx25,0H	DC12V(Default) DC24V(Order)	12V/500mA+-10% 24V/250mA+-10%	280 kg.. (600Lbs)	NO/NC/COM	NO/NC/COM	Single Door

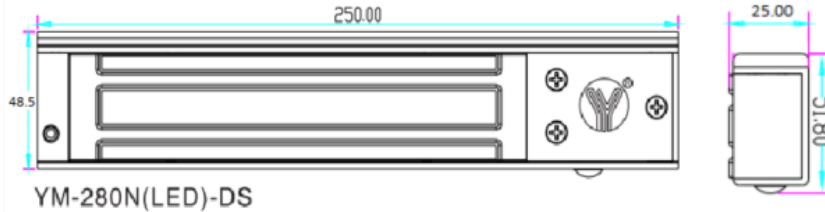

Product Parameter	Parameter Description
Size	250Lx48.8Wx25.0H(mm)
Armature Plate Dimension	180Lx38.8Wx13.2H(mm)
Holding Force	280kg(600Lbs)
Input Voltage	DC12V (Adjustable DC24V)
Current	12V/500mA(±10%) ; 24V/250mA(±10%)
Cover Finish	Anodized aluminum
LED	Red shows locked ;Green shows unlocked
Lock Signal Output	NO while locking and NC for unlocking(Voltage<30VDC;Current<0.5A)
Door Signal Output	NO/NC/COM Door Status Signal Output Contact
Suitable	Wooden door , Glass door ,Metal door , Fireproof door
Surface Temp	≤+20°C
Operating Temp	-20°C~+55°C(-4—131°F)
Humidity	0~95%(non-condensing)
Weight	2.1KG

Different brackets are available according to different types of doors. For example, narrow door, frameless glass door and inward opening door.

**L Bracket-For outward opening door**

When the door frame thickness is less than 42mm, L bracket is needed.

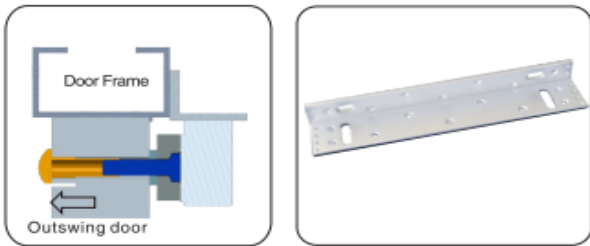

**ZL Bracket-For inward opening door**

For inward opening door, ZL bracket is needed.

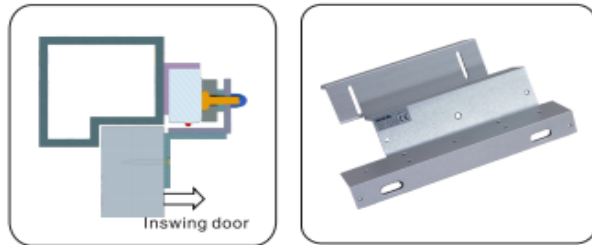

**U Bracket**

For the frameless glass door. U bracket is needed.



**I Bracket for armature plate**

When the door frame is too thick, I bracket is needed.

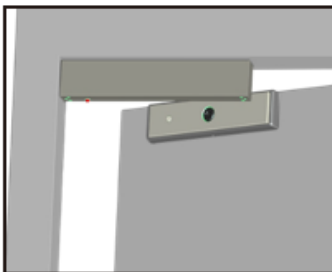
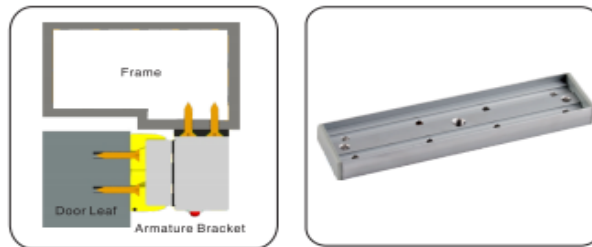

Demonstration of I Bracket Installation

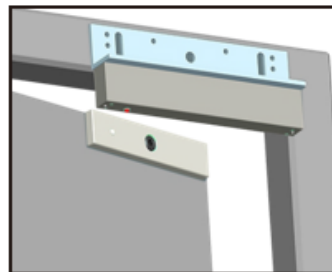

Demonstration of L Bracket Installation

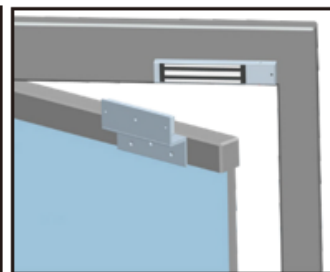

Demonstration of ZL Bracket Installation

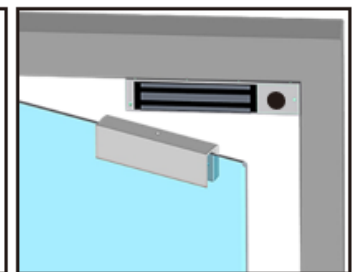

Demonstration of U Bracket Installation